



**MODEL:** CUSA-TR80-18-2400-TH | **DESCRIPTION:** ULTRASONIC SENSOR

**FEATURES**

- aluminium can
- open type
- combination unit: receiver & transmitter
- sensitivity -68 dBV
- detectable range 18 meters



**SPECIFICATIONS**

| parameter             | conditions/description       | min   | typ   | max   | units     |
|-----------------------|------------------------------|-------|-------|-------|-----------|
| type                  | transmitter/receiver         |       |       |       |           |
| operating voltage     | at 39 kHz                    |       |       | 150   | Vp-p      |
| frequency             |                              | 38    | 39    | 40    | kHz       |
| sensitivity           |                              | -68   |       |       | dBV/μMbar |
| sound pressure level  | at 10 V, 30 cm, sine wave    | 115   |       |       | dB        |
| directivity           |                              |       | 80    |       | degree    |
| capacitance           | at 1 kHz                     | 1,920 | 2,400 | 2,880 | pF        |
| detectable range      |                              | 0.2   |       | 18    | m         |
| response time         |                              |       |       | 1.6   | ms        |
| dimensions            | Ø16.0 x 12.0                 |       |       |       | mm        |
| material              | aluminum                     |       |       |       |           |
| terminal              | pins (iron with tin plating) |       |       |       |           |
| weight                |                              |       | 2.31  |       | g         |
| operating temperature |                              | -20   |       | 70    | °C        |
| RoHS                  | yes                          |       |       |       |           |

**SOLDERABILITY**

| parameter      | conditions/description | min | typ | max | units |
|----------------|------------------------|-----|-----|-----|-------|
| wave soldering |                        |     |     | 250 | °C    |

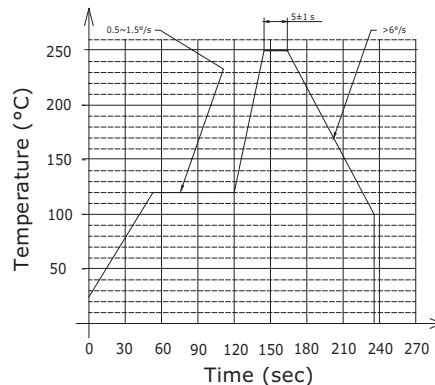

## MECHANICAL DRAWING

units: mm

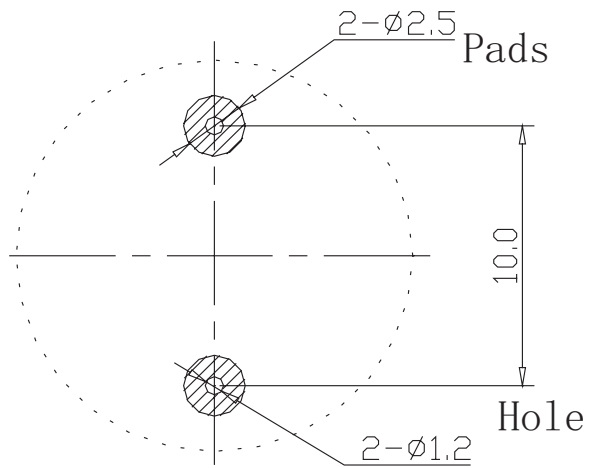
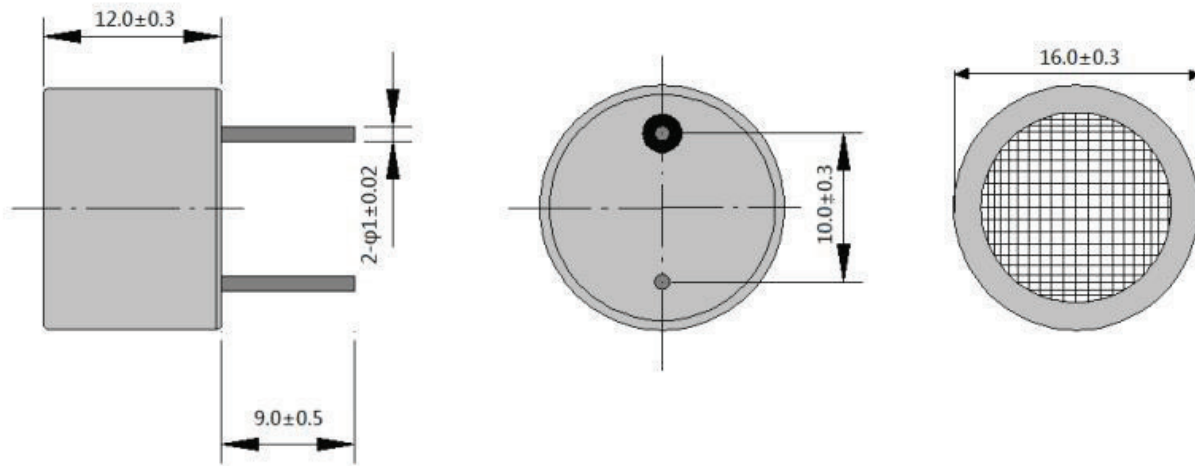

Recommended PCB Layout  
Top View

## BEAM PATTERNS

SPL vs. Frequency [Transmitter]

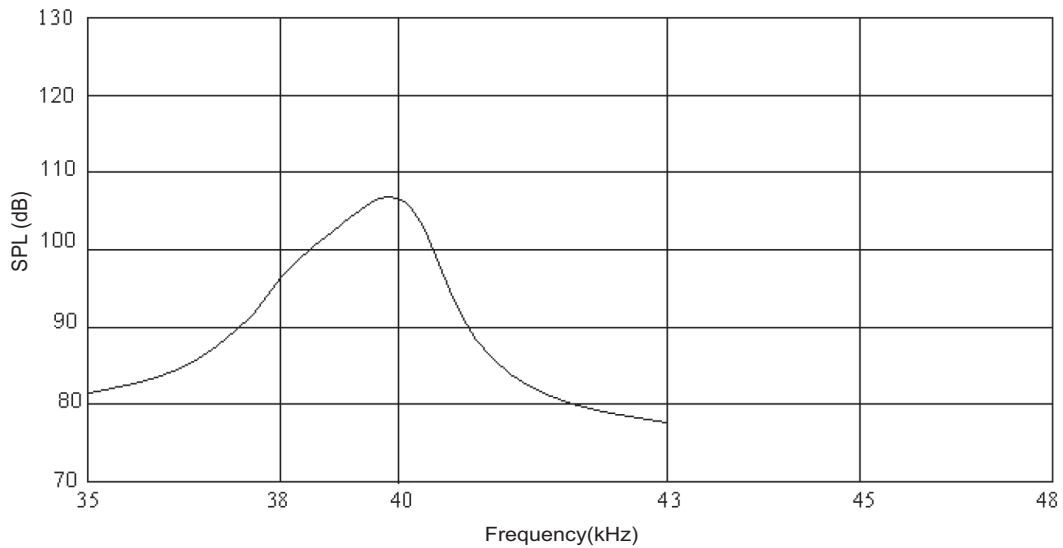

Sensitivity vs. Frequency [Receiver]

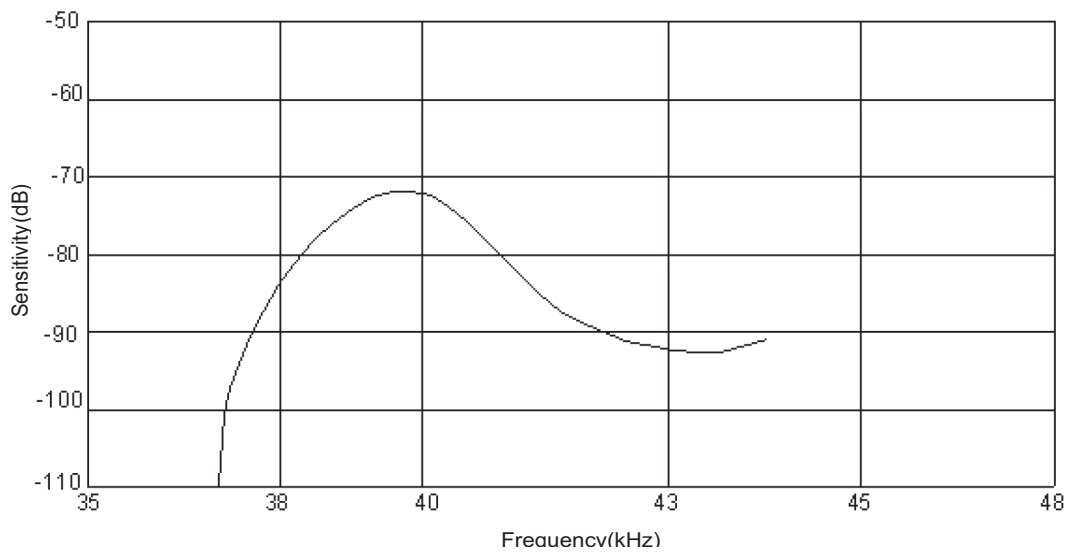

Directivity

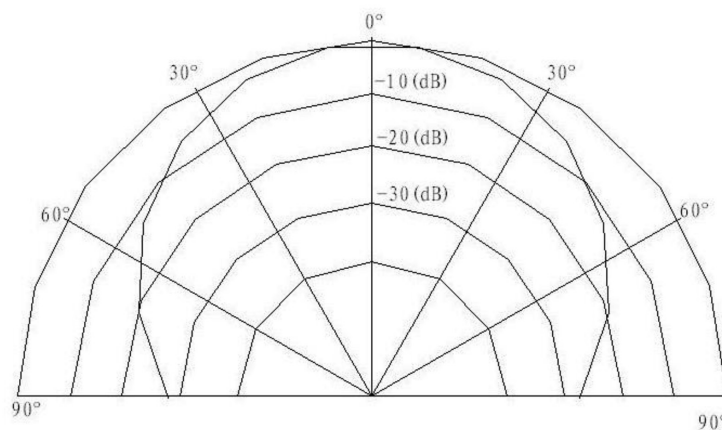

## PACKAGING

units: mm

Tray Size: 240 x 160 x 30 mm  
Tray QTY: 50 pcs per tray  
Carton Size: 480 x 280 x 320 mm  
Carton QTY: 2,000 pcs per carton

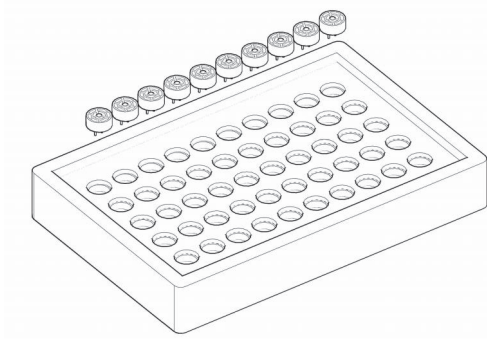

50PCS/BOX  
BOX SIZE:24\*16\*3CM

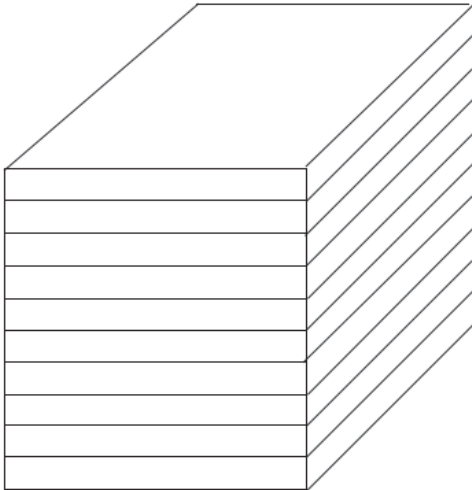

10BOXES/STACK, TOTAL 500PCS  
STACK SIZE:24\*16\*24CM

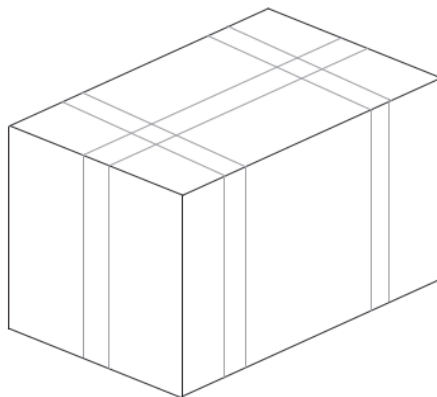

2000PCS/CARTON  
CARTON SIZE:48\*28\*32CM

## REVISION HISTORY

| rev. | description                       | date       |
|------|-----------------------------------|------------|
| 1.0  | initial release                   | 12/02/2020 |
| 1.01 | logo, datasheet style update      | 08/05/2022 |
| 1.02 | CUI Devices rebranded to Same Sky | 09/12/2024 |

The revision history provided is for informational purposes only and is believed to be accurate.



Same Sky offers a one (1) year limited warranty. Complete warranty information is listed on our website.

Same Sky reserves the right to make changes to the product at any time without notice. Information provided by Same Sky is believed to be accurate and reliable. However, no responsibility is assumed by Same Sky for its use, nor for any infringements of patents or other rights of third parties which may result from its use.

Same Sky products are not authorized or warranted for use as critical components in equipment that requires an extremely high level of reliability. A critical component is any component of a life support device or system whose failure to perform can be reasonably expected to cause the failure of the life support device or system, or to affect its safety or effectiveness.

[sameskydevices.com](https://www.sameskydevices.com)